

REV 版本	DESCRIPTION 描述	DATE 日期
A	First issue	MAY-05-2008
B	Add inject port	MAY-21-2008

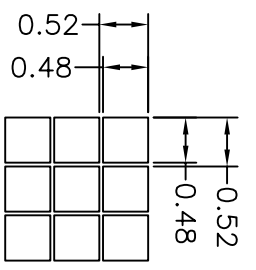
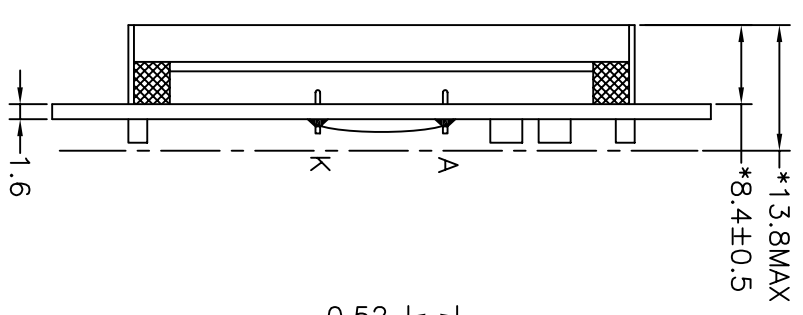
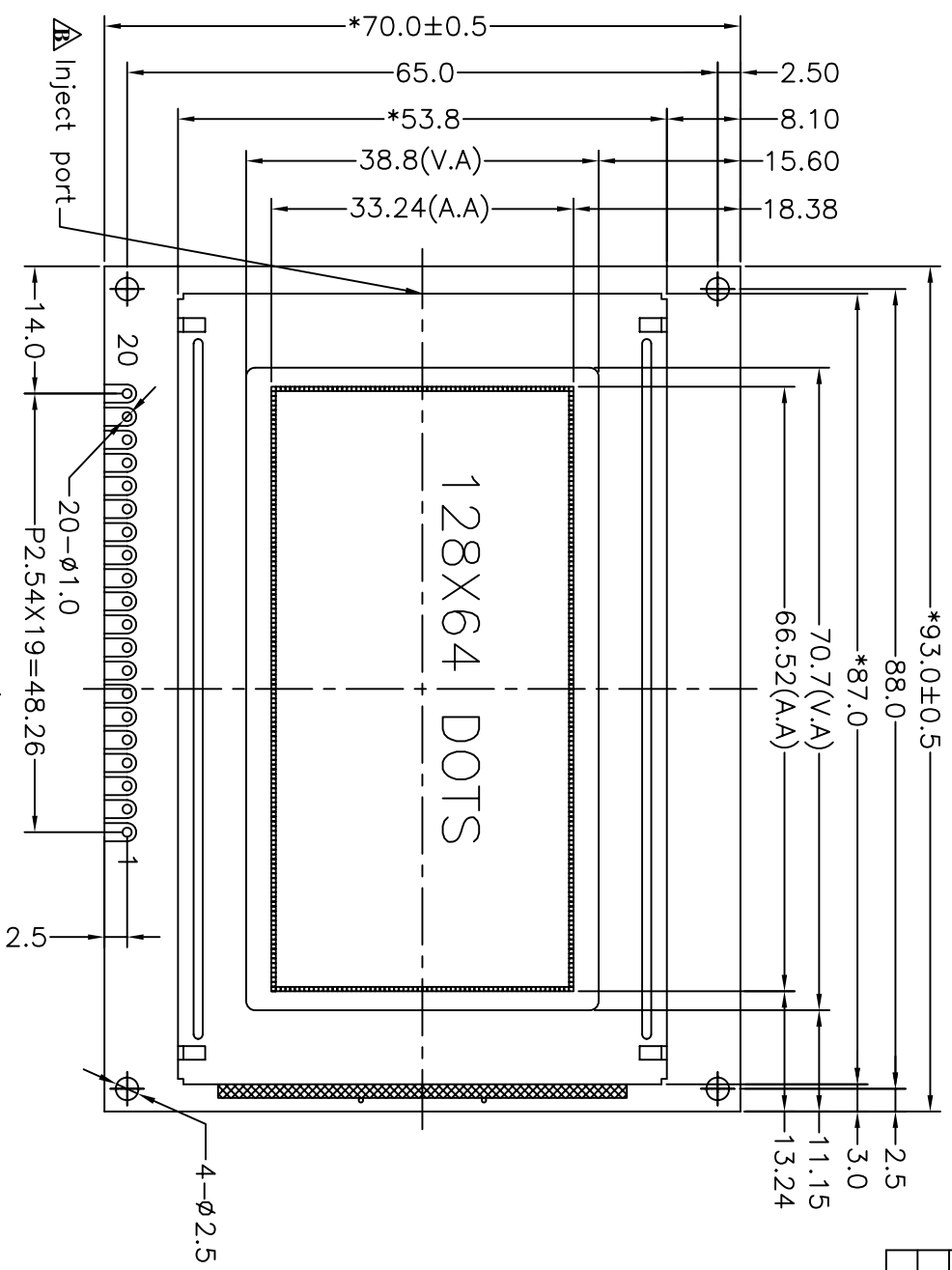

DOTS DETAIL  
SCALE:10/1

VIEWING DIRECTION

PIN	1	2	3	4	5	6	7	8	9	10
CONNECTION	VSS	VDD	VO	RS	R/W	E	DB0	DB1	DB2	DB3
PIN	11	12	13	14	15	16	17	18	19	20
CONNECTION	DB4	DB5	DB6	DB7	/CS1	/CS2	RST	VEE	LEDA	LEDK

Specification:

- 1). Driving: Duty:1/64, Bias:1/6, VLCD:8.0V(Ref), VDD:5.0V
- 2). Viewing angle: 6 O'clock
- 3). Display mode: FSTN/Positive/Transflective
- 4). Operating temp.: -20°C~+70°C  
Storage temp.: -30°C~+80°C
- 5). IC: SBN0064G-D (or compatible)
- 6). Backlight: Side Blue
- 7). Dimensions with mark "\*" are important, with mark "(") are referenced
- 8). All the raw materials are RoHS compliant

**深圳秋田微电子有限公司**  
SHENZHEN AVIDISPLAY CO., LTD.

PART NO: 零件编号	C/D 结构图	PROJECTION 三角法	MODULE NUMBER 模组型号	SCALE 比例	FTT 适应图面
ABG128064A06-FHB-R-01			ABG128064A06-FHB-R-01	SHEET: 页次	1 OF 1
				GENERAL TOL: 公差	±0.3
				APPROVALS 签字	DATE 日期
				CHK: DWN:	