

REV 版本	DESCRIPTION 描述	DATE 日期
A	First issue	DEC-24-2007
B	Change CONNECTION	DEC-27-2007

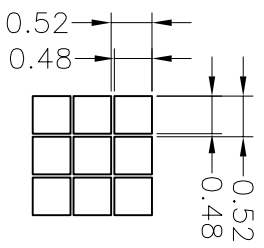
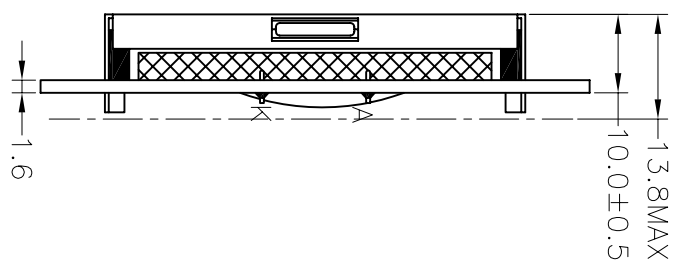
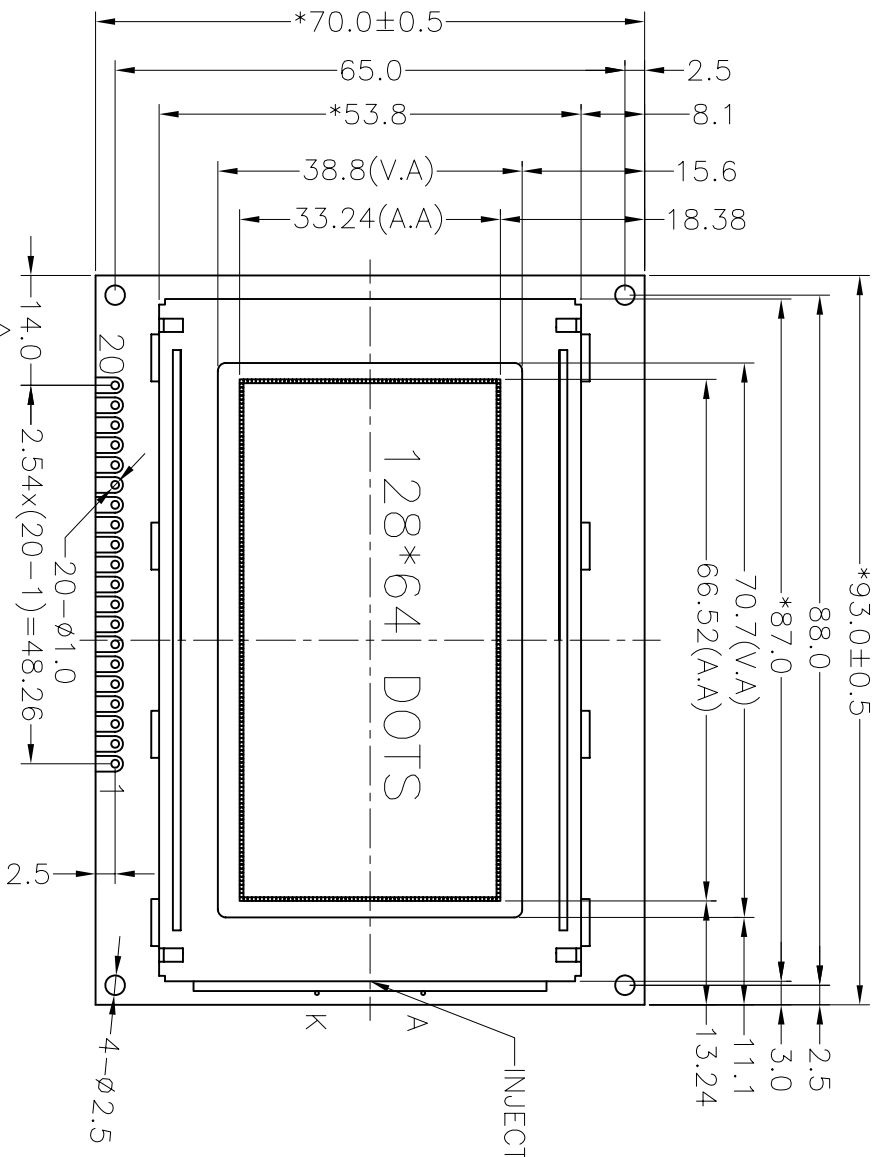

Specification:

- 1). Driving: Duty:1/32, Bias:1/5, VLCD:5.2V, VDD:3.3V Or 5.0V
- 2). Viewing angle: 6 O'clock
- 3). Display mode: STN/Positive/Transflective/Y-G
- 4). Operating temp.: -20°C~+70°C
- 5). Storage temp.: -30°C~+80°C
- 6). IC: ST7920(or compatible)
- 7). Backlight: Side;Yellow—Green
- 8). Dimensions with mark "*" are important, with mark "()" are referenced
- 8). All the raw materials are ROHS compliant

PIN	1	2	3	4	5	6	7	8	9	10
CONNECTION	VSS	VDD	VO	RS/CS	RW/SD	E/CLK	DB0	DB1	DB2	DB3
PIN	11	12	13	14	15	16	17	18	19	20
CONNECTION	DB4	DB5	DB6	DB7	PSB	NC	/RST	VR	LEDA	LEDK

深圳秋田微电子有限公司
SHENZHEN AVIDISPLAY CO.,LTD.

PART NO: 零件编号	C/D结构图	PROJECTION 三角法	MODEL NUMBER 模组型号	SCALE 比例	FTT 适应图面
ABG128064G03-YHY-R			ABG128064G03-YHY-R	SHEET: 页次	1 OR 1
				GENERAL TOL: 公差	±0.3
				UNIT 单位	mm
				DATE 日期	
				APP: 签字	
				CHK: 签字	
				DWN: 签字	

DO NOT SCALE THIS DRAWING.