

REV 版本	DESCRIPTION 描述	DATE 日期
A00	First issue	JUN-05-2006

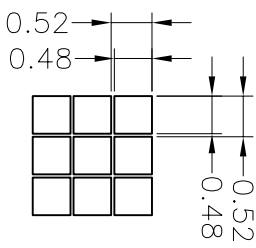
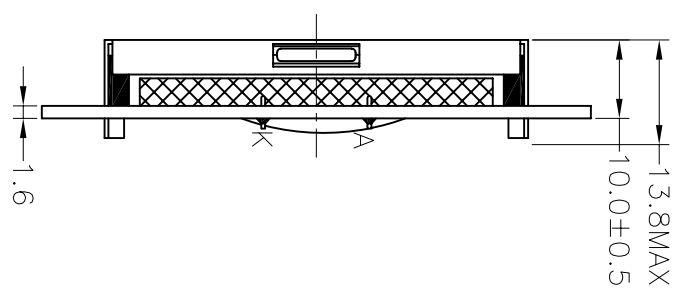
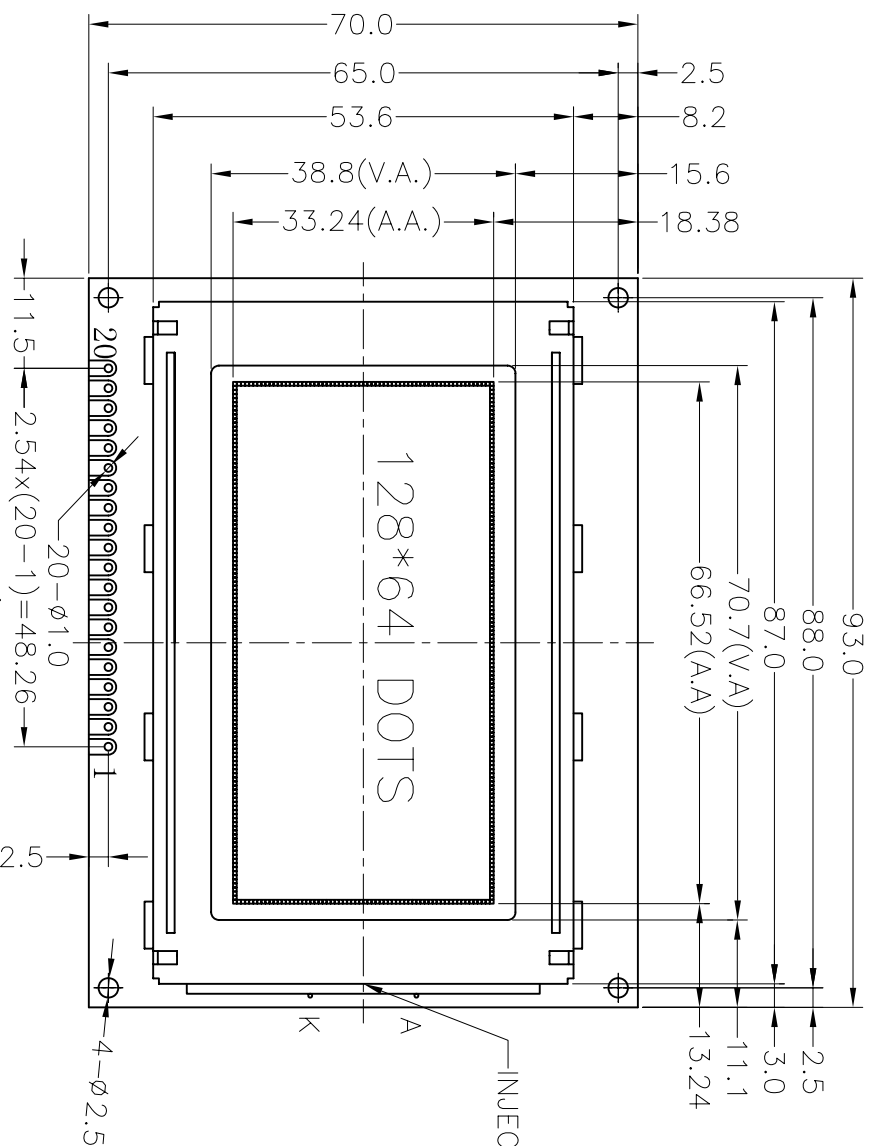

Specification:

- 1). Driving: Duty:1/32, Bias:1/5, VLCD:5.2V, VDD:5.0V
- 2). Viewing angle: 6 O'clock
- 3). Display mode: STN/Positive/Transflective/Grey
- 4). Operating temp.: -20°C~+70°C
- 5). Storage temp.: -30°C~+80°C
- 6). IC: ST7920
- 7). Backlight: Side;White
- 8). Dimensions with mark "*" are important, with mark "()" are referenced

PIN	1	2	3	4	5	6	7	8	9	10
CONNECTION	VSS	VDD	NC	RS(CS)	R/W(S/D)	E(SCLK)	DB0	DB1	DB2	DB3
PIN	11	12	13	14	15	16	17	18	19	20
CONNECTION	DB4	DB5	DB6	DB7	PSB	NC	/RST	NC	LEDA	LEDK

		深圳秋田视佳实业有限公司 SHENZHEN AV-DISPLAY CO., LTD	
PART NO: 零件编号	C/D结构图	PROJECTION 三角法	MODEL NUMBER 模组型号
FAV-ABG128064G01-00			ABG128064G01-GHW
SCALE: FIT 适应图面		SHEET: 1 OF 1	
GENERAL TOL: ±0.3		UNIT 公差	
APP: 签字	DATE	CHK: 日期	DWN: 日期