

REV 版本	DESCRIPTION 描述	DATE 日期
A00	First Issue	MAR-20-2007

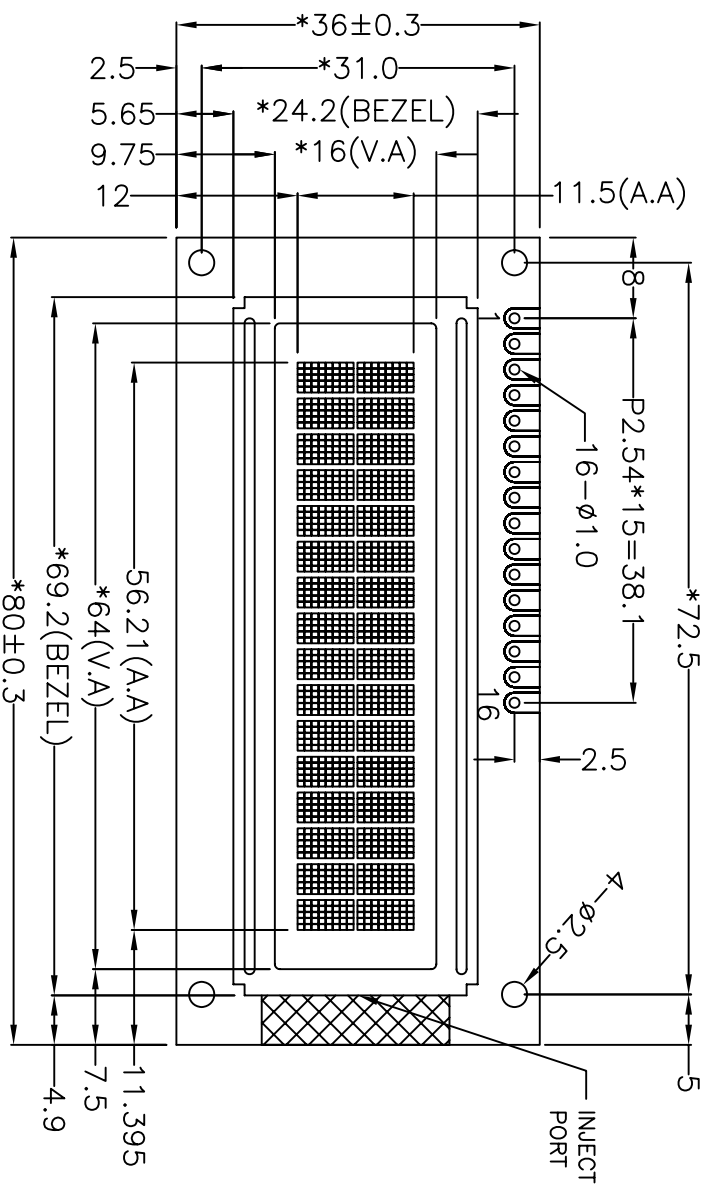

VIEWING DIRECTION

- Specification:
- 1). Driving: Duty:1/16, Bias:1/5, Vlcd:4.5V, Vdd:5.0V
 - 2). Viewing direction: 6 O'clock
 - 3). Display mode: FSTN/Positive/Transflective
 - 4). Operating temp.: -20°C~+70°C
Storage temp.: -30°C~+80°C
 - 5). Drive ic: S6A0069X01-COCX
 - 6). Backlight type: Edge Red
 - 7). Dimensions with mark "*" are important, with mark "()" are referenced
 - 8). All the raw materials are RoHS compliant

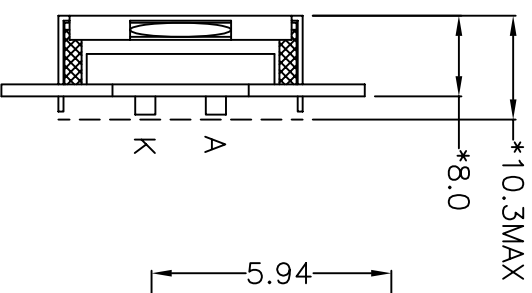

DOTS SIZE
SCALE: 4/1

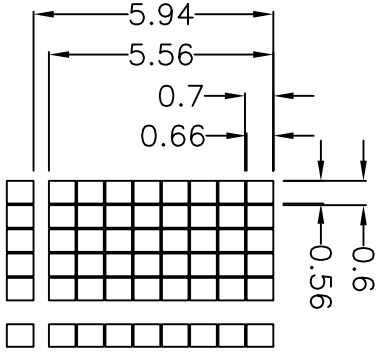

PIN	1	2	3	4	5	6	7	8
CONNECTOR	VSS	VDD	VO	RS	R/W	E	DB0	DB1
PIN	9	10	11	12	13	14	15	16
CONNECTOR	DB2	DB3	DB4	DB5	DB6	DB7	LEDA	LEDK

深圳市秋田视佳实业有限公司
SHENZHEN AVDISPLAY CO.,LTD.

PART NO: 零件编号	CD 结构图	PROJECTION 三角法	MODEL NUMBER 模组型号	SCALE 比例	FIT 适应图面
FAY-ABC016002E43-R-00			ABC016002E43-FIB-R	SHEET 页次	1 OF 1
				GENERAL TOL: 公差	±0.3
				APPROVALS 签字	DATE 日期
				CHK: DWN:	