

REV 版本	DESCRIPTION 描述	DATE 日期
A	First issue	APR-26-2008

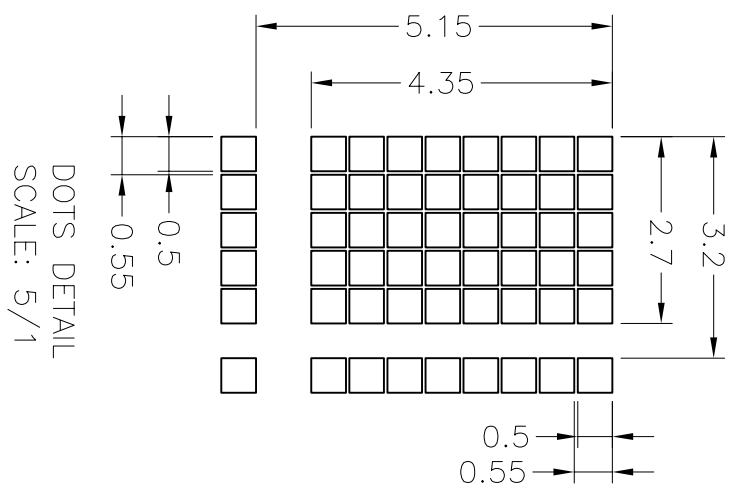

VIEWING DIRECTION

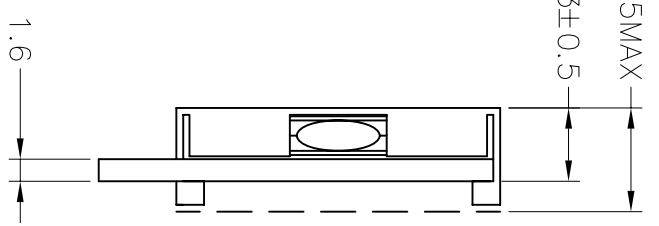
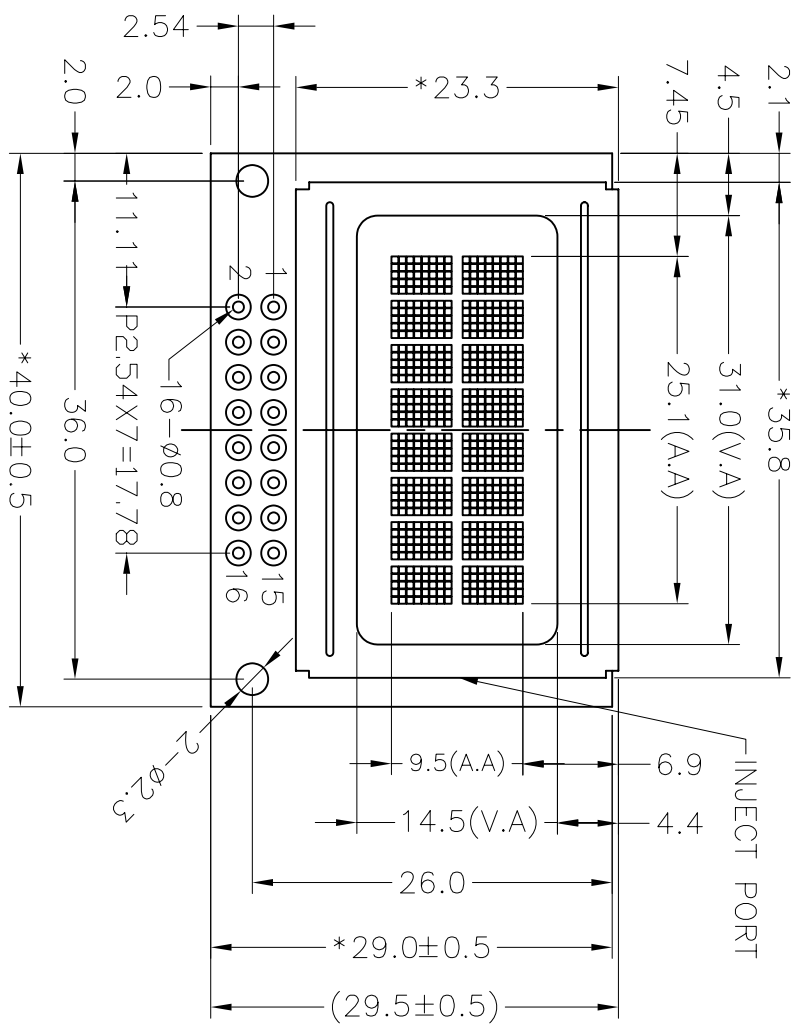

- Specification:
- 1). Driving: Duty:1/16, Bias:1/5, VLCD:4.5V, VDD:5.0V
 - 2). Viewing direction: 6 O'clock
 - 3). Display mode: STN/Positive/Reflective/Gray
 - 4). Operating temp.: -20°C~+70°C
Storage temp.: -30°C~+80°C
 - 5). IC:SP1C780D1-001A-C(Or Compatible)
 - 6). LCD Protect From Ultraviolet radiation
 - 7). Dimensions with mark "*" are important, with mark "()" are referenced
 - 8). All the raw materials are RoHS compliant.

PIN	1	2	3	4	5	6	7	8
CONNECTOR	R/W	E	RS	VO	VDD	VSS	NC	NC
PIN	9	10	11	12	13	14	15	16
CONNECTOR	DB0	DB7	DB1	DB6	DB2	DB5	DB3	DB4

DOTS DETAIL
SCALE: 5/1

深圳秋田电子有限公司
SHENZHEN AV-DISPLAY CO., LTD.

PART NO: 零件编号	C/D 结构图	PROJECTION 三角法	MODEL NUMBER 模组型号	SCALE 比例	FTT 适应图面
ABC008002B06-GGN-R				1	1
GENERAL TOL: ±0.3			SHEET: 1	OR	1
APP:			APPROVALS	DATE	UNIT 单位
CHK:			DWN:	DATE	mm

DO NOT SCALE THIS DRAWING.