

REV 版本	DESCRIPTION 描述	DATE 日期
A	First issue	Jun-06-2008

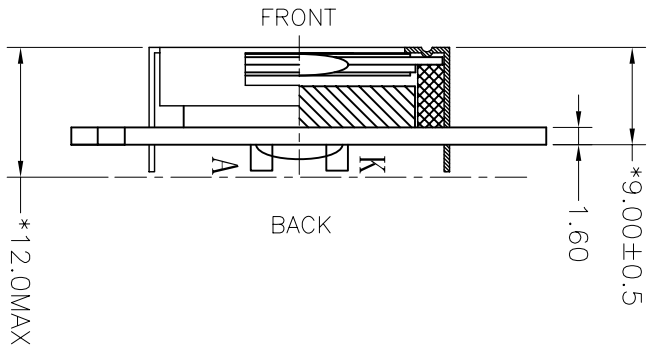

VIEWING DIRECTION

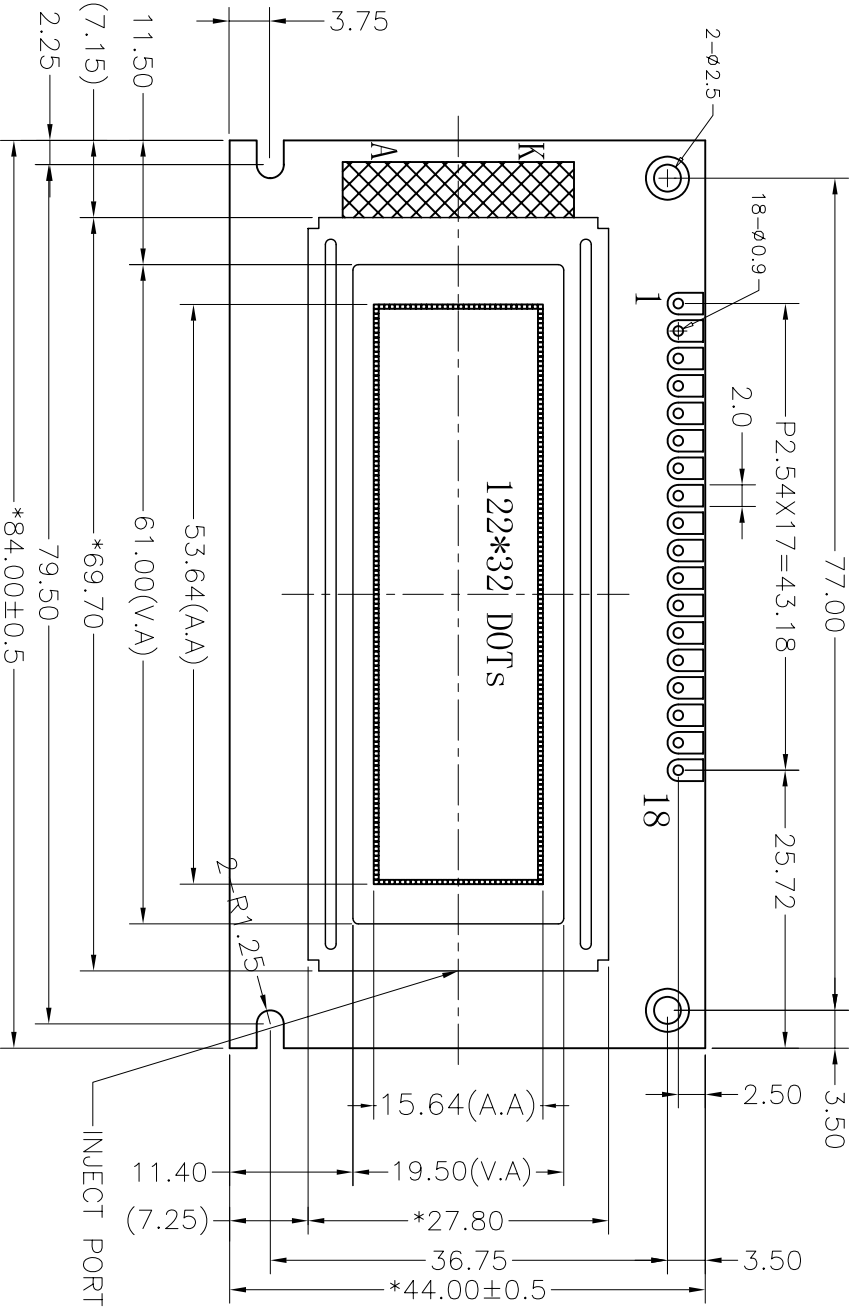
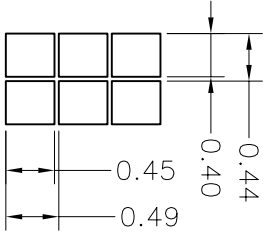

PIN	1	2	3	4	5	6	7	8	9
CONNECTION	VSS	VDD	V0	A0	E1	E2	RW	D0	D1
PIN	10	11	12	13	14	15	16	17	18
CONNECTION	D2	D3	D4	D5	D6	D7	RES	LED A	LED K

- Specification:
- 1). Driving: Duty:1/32, Bias:1/5, VLCD:4.8V, VDD:5.0V
 - 2). Viewing angle: 6 0'clock
 - 3). Display mode: STN/Negative/Transmissive/Blue
 - 4). Operating temp.: -20°C~+70°C
 - 5). Storage temp.: -30°C~+80°C
 - 6). IC: PT6520
 - 7). Backlight: Side, White
 - 8). Dimensions with mark "*" are important, with mark "()" are referenced
 - 8). All the raw materials are RoHS compliant.



深圳秋田微电子有限公司
SHENZHEN AYO DISPLAY CO.,LTD.

PART NO: 零件编号	C/D结构图	PROJECTION 三角法	MODULE NUMBER 模组型号	SCALE 比例	FTT 适应图面
ABG122032H03-BIW-R			ABG122032H03-BIW-R	1:1	OR 1
				GENERAL TOL: ±0.3	UNIT 单位 mm
				APP: 签字	DATE 日期
				CHK: 签字	
				DWN: 签字	